

V5 Lubricator

Continuous Duty, Motor-driven



General

V5 Lubricator consists of a gear pump driven by 115 VAC electric motor, pressure switch, line filter, bypass valve and 6 liter metal reservoir.

Technical Data

| | |
|-----------------------------|---------------------------|
| Reservoir | 6 liter (metal) |
| Voltage | Single phase, 115 VAC |
| Current | .69/.93 amp, 60/50 Hz |
| Features | Thermally protected, TENV |
| Maximum Ambient Temperature | 104°F (40°C) |

Discharge Adjustment

A bypass valve is provided to regulate the system pressure and oil delivery. Turning the valve counter-clockwise will decrease oil pressure and delivery. Lubricator is preset with bypass valve closed for maximum discharge of 110cc per minute(50Hz) and maximum pressure of 75 psi.

System Limitations

Oil is delivered to bearing surfaces through flow proportioning Type C control units. Viscosity range is 150 to 8,000 SSU at operating system temperature. (See *Bijur Engineering Manual* for system limitations. Use only Bijur Delimon approved lubricants.)

Lubricator is equipped with a pressure switch which closes electrical contacts on pressure rise at 30 psi. Adjust needle valve after sufficient warm-up time to maintain at least 30 psi operating pressure.

Assembly is furnished with 25P micron (nominal) porous bronze filter. Element should be periodically inspected (at least annually) and replaced as necessary.

How to Order

| Name | Part # |
|---------------|---------|
| V5 Lubricator | 27249-1 |

When ordering, specify name and part number, such as: V5 Lubricator, Part #27249-1.

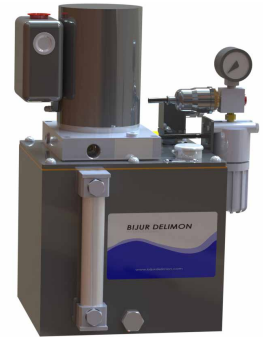

Failure to properly ground lubricator may result in serious electrical shock.

BIJUR DELIMON INTERNATIONAL

(919) 465 4448 LOCAL
(800) 631 0168 TOLL-FREE
(919) 465 0516 FAX

WWW.BIJURDELIMON.COM

2250 Perimeter Park Dr., Suite 120
Morrisville, NC 27560

Service Parts

Order by part number and name description shown below. When ordering parts, be sure to specify complete lubricator part number and serial letters shown on nameplate. For major repairs requiring parts not shown in illustration, return lubricator for factory rebuilding and adjustment.

| Item | Part # | Description |
|------|---------|----------------------------------|
| 1 | AC368-1 | Low Level Switch (DIN Conn, N/O) |
| 2 | 29943 | Pressure Switch 30 psi, N/O |
| 3 | 23522 | Pressure Gauge |
| 4 | B5880 | Check Valve |
| 5 | 19848 | Filter Assembly |
| 6 | B6890 | Replacement Element Only |
| 7 | 19030 | Fill Strainer |
| 8 | B9602 | Drain Plug |
| 9 | H0413 | O-Ring |
| 10 | 24342 | Filter Assembly |
| 11 | 24116-6 | Sight Glass |
| 12 | B9943 | Relief Valve (75 psi) |
| 13 | 25937-1 | Gear Pump |
| 14 | 27247 | Oil Reservoir (6 liter) |
| 15 | 24041 | Reservoir Gasket |
| 16 | 36400 | Motor, 115V (TENV) |

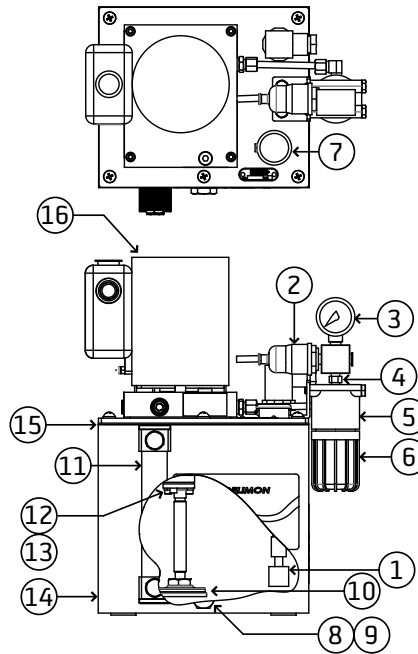

ATTENTION

Use clean oil only of the type and viscosity recommended by machine manufacturer.

ATTENTION

Replace filter group annually.

Dimensional Schematics

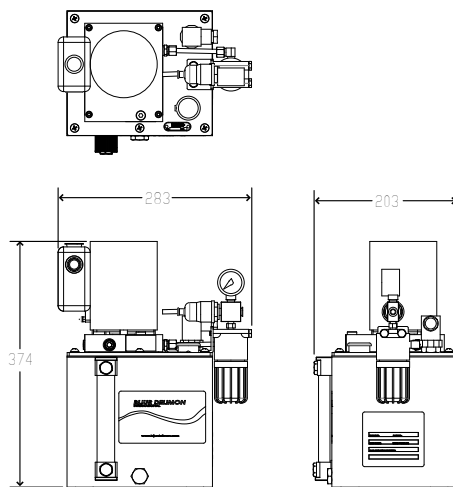

Motor Connection Diagram

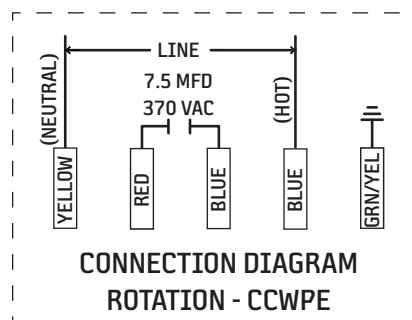

Low Level Switch Connection

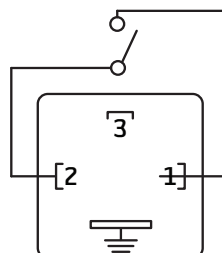

BIJUR DELIMON INTERNATIONAL

(919) 465 4448 LOCAL
(800) 631 0168 TOLL-FREE
(919) 465 0516 FAX

WWW.BIJURDELIMON.COM

2250 Perimeter Park Dr., Suite 120
Morrisville, NC 27560