

Gear Pumps

Rotary Drive, Oil



General

Gear pumps are driven from a rotating machine shaft either direct or by means of a gear or chain drive of suitable ratio. Direction of drive is established by looking at exposed end of pump drive shaft. When installed with suction head, inlet valve #B5892 should be used (as shown in *Data Sheet #24796*).

Technical Data

Drive Speed	20 rpm minimum to 1000 rpm maximum
Discharge Rate	Approximately 50cc per minute per 100 rpm
Maximum Operating Pressure Range	180 psi

How to Order

Name	Description	Part #
Gear Pump	Sump mounting	C2347
	Sealed, external mounting	C2448
	Sealed, external mounting	C3191

When ordering, specify by name, description and part number, e.g. Gear pump, sump mounting, Part #C2347.

Dimensional Schematics

Sump Mounting (#C2347)*

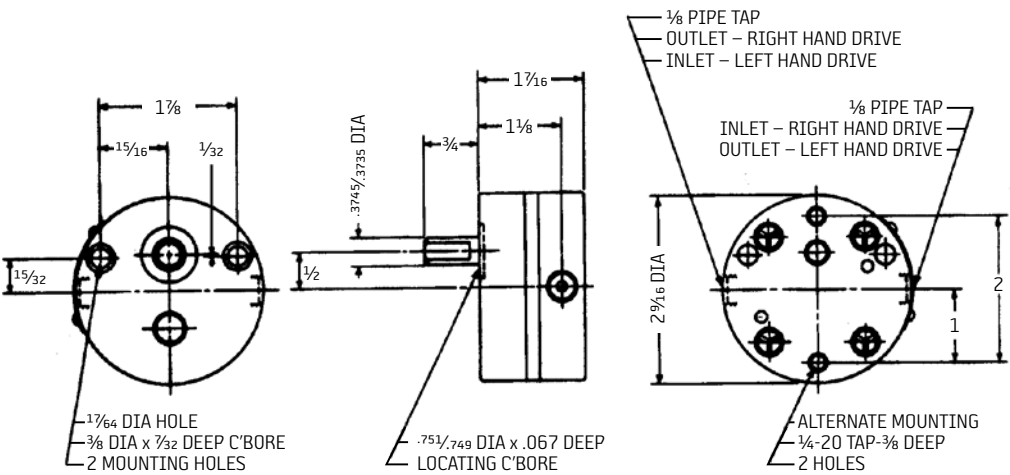

Measurements shown in inches.

* Inlet tubing size: 1/4" O.D. maximum.
Suction head: 6 inches maximum.

BIJUR DELIMON INTERNATIONAL

(919) 465 4448 LOCAL
(800) 631 0168 TOLL-FREE
(919) 465 0516 FAX

WWW.BIJURDELIMON.COM

2100 Gateway Centre Blvd., Suite 109
Morrisville, NC 27560

Sealed, External Mounting (#C2448)

Measurements shown in inches.

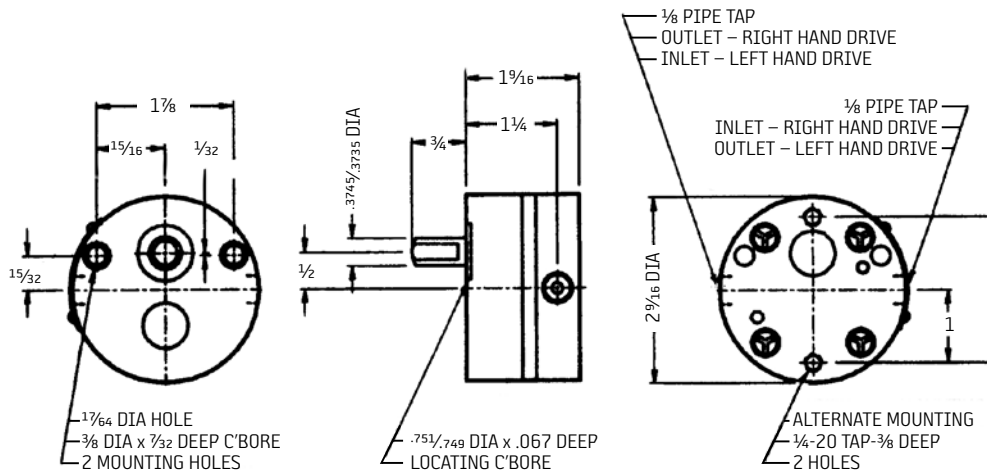

Sealed, External Mounting (#C3191)

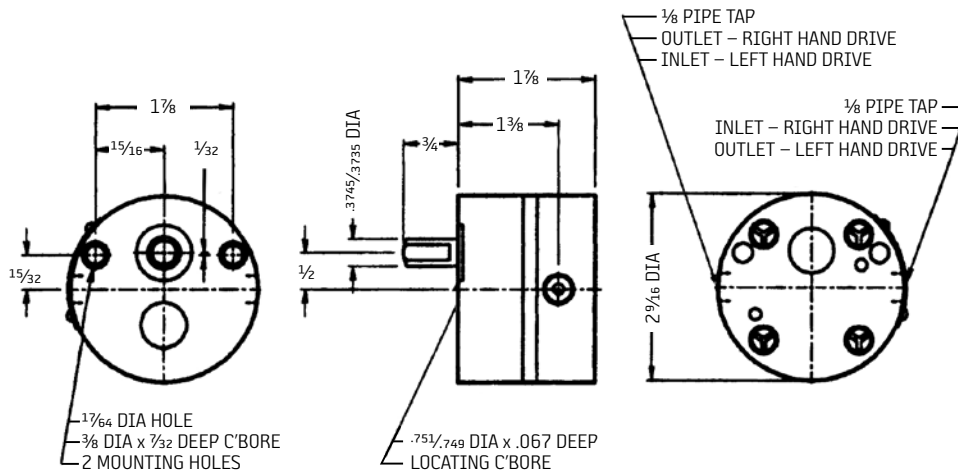

BIJUR DELIMON INTERNATIONAL

(919) 465 4448 LOCAL
(800) 631 0168 TOLL-FREE
(919) 465 0516 FAX

WWW.BIJURDELIMON.COM

2100 Gateway Centre Blvd., Suite 109
Morrisville, NC 27560