

Electric Drum Pumps

Grease

General

Farval's AC or DC Electric Barrel Pumps will replace the air or hydraulic operated pumps now used for lubrication systems on mobile or stationary equipment. Installation is cleaner - no air or hydraulic lines to install/leak. Simply wire into the machines 12, 24, or 110 Volt supply. Pressure rated to 4000 psi. Will fit original refinery 35 and 120 lb drums. All models include drum cover and follower plate.

Operation

12/24 VDC

The pump end (bottom) consists of a hardened steel bushing, through which the piston runs. As the piston strokes down, grease is pushed past the check valve ball and out through the extruded discharge holes in the pump stem. As the piston strokes up, the check valve prevents drawback, and a vacuum is created inside the bushing. When the piston uncovers the suction holes in the bushing, another charge of grease is drawn in through the suction ports on the bottom of the stem and into the bushing. The cycle then repeats.

115 VAC

The 115VAC Pumps use a 1/4 hp., open drip-proof gear motor, with a cam and roller follower to actuate the pump plunger. Bottom-end (pump) is identical to the DC units.



Refer to the following datasheets:

- + Datasheet #35972:
FEP300-400 Series Drum Pumps
- + Datasheet #35973:
FEP700 Series Drum Pumps
- + Datasheet #35974:
FEP800 Series Drum Pumps

Technical Data

Drum Size		35 lb, 120 lb
Voltage		12/24 VDC, 115/230 VAC (50/60 Hz)
Lubrication Flow	12 VDC	14 cu. in./min (229cc/min)
	24 VDC	FEP712 11 cu. in./min (180cc/min)
		FEP724 4.8 cu.in./min (79cc/min)
	115VAC	8.7 cu. in./min (142cc/min)
	220VAC	8.7 cu. in./min (142cc/min)
Lube Outlet Port		1/4" NPT (F)

BIJUR DELIMON INTERNATIONAL

(919) 465 4448 LOCAL
(800) 631 0168 TOLL-FREE
(919) 465 0516 FAX

WWW.BIJURDELIMON.COM

2100 Gateway Centre Blvd., Suite 109
Morrisville, NC 27560

How to Order

ATTENTION

Lubricant containers supplied by others.

Name	Voltage	Amp Draw Spike	Drum Size	Part #	Part # ⁴	Max Pressure
Electric Drum Pump	12 VDC	80 amp ¹	35 lb	FEP312	FEP312V	4000 psi
			120 lb	FEP322	FEP322V	4000 psi
	24 VDC	40 amp ²	35 lb	FEP712C	FEP712V	3500 psi
				FEP724C	-	7500 psi
	115VAC	5 amp ³	120 lb	FEP722C	FEP722V	3500 psi
			35 lb	FEP812	FEP812V	3500 psi
	220VAC	5 amp ³	120 lb	FEP822	FEP822V	3500 psi
				-	FEP822V220	3500 psi

¹ 15-20 amp draw @ free flow. 30-40 amp draw @ 3000 psi.

³ 5 amp draw @ free flow. 5 amp draw @ 3000 psi.

² 10 amp draw @ free flow. 15-20 amp draw @ 3000 psi.

⁴ Pump comes with a vent valve.

When ordering, specify by name, description and part number, e.g. Electric Drum Pump, 12 VDC, 80 Amp Draw Spike, 120 lb Drum, Part #FEP322.

Dimensional Schematics

Measurements shown in inches.

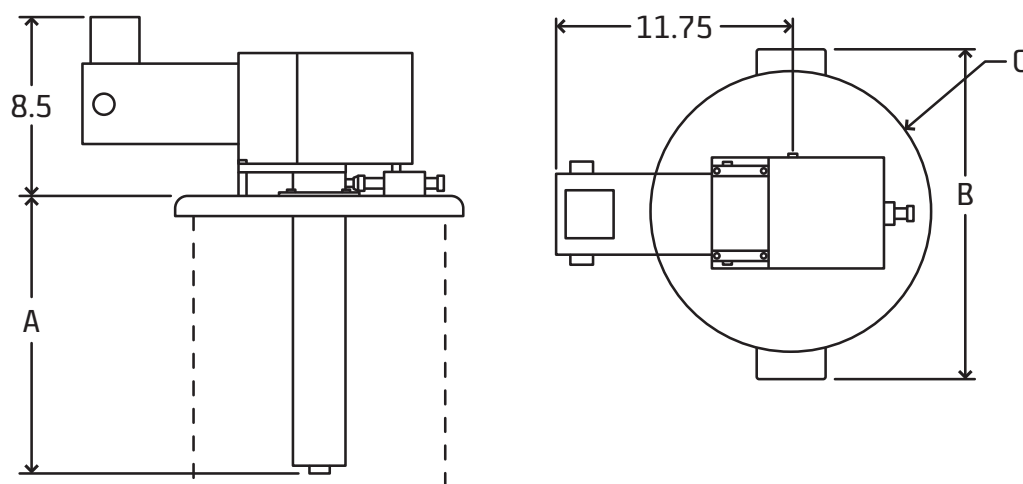

	A	B	C
35 lb Drum	13"	14.625"	12.5"
120 lb Drum	25.5"	17.5"	15.125"

BIJUR DELIMON INTERNATIONAL

(919) 465 4448 LOCAL
(800) 631 0168 TOLL-FREE
(919) 465 0516 FAX

WWW.BIJURDELIMON.COM

2100 Gateway Centre Blvd., Suite 109
Morrisville, NC 27560