

V5 Lubricator

Continuous Duty

General

The system consists of the following three basic elements:

1. Lubricator
2. Distribution tubing
3. Control units

The V5 Lubricator forces a constant flow of oil into a single line of distribution tubing branched to supply oil to the bearing surfaces through control units which proportion the correct oil film to each bearing.

Operation

The V5 Lubricator consists of a motor-driven gear pump with a controlled constant volume discharge. The fully automatic lubricating system is preset by the machine manufacturer for best operation.

Technical Data

Motor	TENV	1/20 hp, NEMA Frame L330, totally enclosed, non-ventilated
	TEFC	1/20 hp, NEMA Frame L330, totally enclosed, fan cooled
Voltage	115 VAC	
Frequency	50/60 Hz	
Speed	1425/1725 rpm	
Start Amperage	2.3/2.5 amp	
Run Amperage	0.67/0.78 amp	
Maximum Ambient Temperature	104°F (40°C)	
Inlet Filter	125 Micron	

Discharge Adjustment

The V5 Lubricator is pre-set with a maximum discharge of 80cc per minute (67cc with a 50 cycle motor). Pressure is limited internally to 130 psi by a relief valve.

System & Limitations

Use Type C control units. Viscosity range is 100 to 10,000 SSU at operating temperature. See Bijur Engineering Manual for system limitations.



60639 Lubricator

ATTENTION

Use clean oil only of the type and viscosity recommended by machine manufacturer.

ATTENTION

Replace filter group annually.

BIJUR DELIMON INTERNATIONAL

(919) 465 4448 LOCAL
(800) 631 0168 TOLL-FREE
(919) 465 0516 FAX

WWW.BIJURDELIMON.COM

2250 Perimeter Park Dr., Suite 120
Morrisville, NC 27560

Startup Instructions

1. Fill reservoir with oil.
2. Start machine and see that oil flows at all bearings.

Maintenance

Check oil level daily and refill reservoir when required. Check the system periodically for loose or broken tubing, worn hoses, loose fittings and connections. Replace filter group annually.

Filter Replacement

An inlet filter provides primary protection of the lubricating system. The filters should be inspected every six months. If not clean, replace. To replace pump filter, unscrew filter assembly and replace with new assembly.

Motor Replacement

1. Disconnect the electrical supply from the motor, disconnect system tubing and remove lubricator unit from the oil reservoir.
2. Turn the lubricator unit upside down and remove the filter inlet connector rod / filter from the pump by turning the hex of the filter carefully in a counter-clockwise direction. Also remove the inlet gear pump adaptor and O ring that connect the inlet filter rod to the gear pump.
3. Remove the two M4 SHC screws holding the gear pump to the downspout and remove the gear pump. Remove the three #8-32 socket cap screws holding the downspout onto the motor adaptor plate and lift the downspout clear from the motor / adaptor plate.
4. Carefully pull the motor driveshaft / motor coupling from the motor shaft.
5. Replace the motor and carefully re-assemble the motor driveshaft / motor coupling onto the new motor shaft. The motor coupling must be equally spaced between the motor driveshaft and the motor shaft.
6. Re- assemble the downspout onto the motor by carefully lining up the three holes and inserting and tightening the three #8-32 socket cap screws.
7. Re-assemble the gear pump to the downspout, ensuring that the shaft of the gear pump meshes with the motor driveshaft. Place the inlet gear pump adaptor and O ring onto the gear pump and then insert the two M4 SHC screws to hold in place.
8. Re-assemble the filter inlet connector rod / filter into the gear pump adaptor.

BIJUR DELIMON INTERNATIONAL

(919) 465 4448 LOCAL
(800) 631 0168 TOLL-FREE
(919) 465 0516 FAX

WWW.BIJURDELIMON.COM

2250 Perimeter Park Dr., Suite 120
Morrisville, NC 27560

How to Order

Name	Reservoir Capacity	Motor	Part #
V5 Lubricator	1 liter	TENV	60639
	4 liter	TEFC	60970
		TENV	60970-1

When ordering, specify name, reservoir capacity, motor and part number, e.g. V5 Lubricator, 1 liter, TENV Motor, Part #60639.

Service Parts 60639

Item	Description	Part #
1	Pump block gasket	86903-1
2	Gear pump	25937-1
3	Relief valve 130 psi	86898
4	Thread adapter	86131
5	Check valve 0 lb.	810908
6	Coupling 1/8NPTF	86539
7	Elbow 1/8NPT	A2768
8	Inlet filter assembly	85909

Item	Description	Part #
9	Motor	36400
10	Pump adapter	60715
11	Thread adapter	86963
12	Reservoir	20324-3
13	Reservoir gasket	21433
14	Street elbow 1/2NPTF	88930-1
15	Filler cap	HF703

Notes:

P.N. 60639 Replaced P.N. D4015-1

P.N. 60970 Replaced P.N. D4018

P.N. 60970-1 Replaced P.N. D4018-1

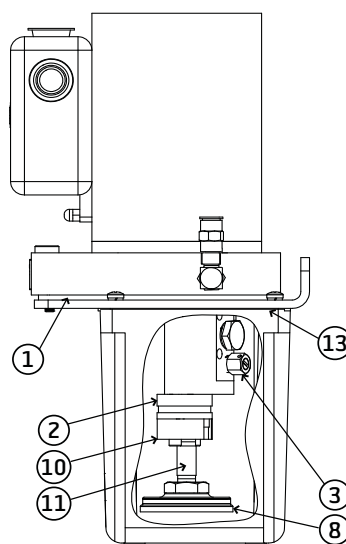
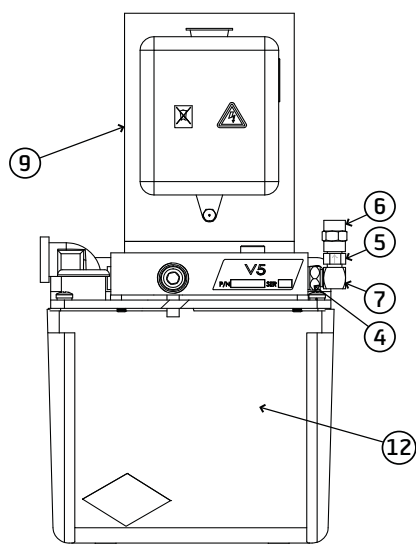
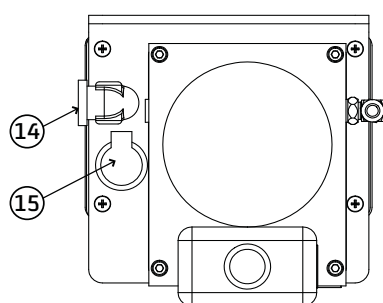

BIJUR DELIMON INTERNATIONAL

(919) 465 4448 LOCAL
(800) 631 0168 TOLL-FREE
(919) 465 0516 FAX

WWW.BIJURDELIMON.COM

2250 Perimeter Park Dr., Suite 120
Morrisville, NC 27560

Service Parts 60970 & 60970-1

Item	Description	Part #
1	Reservoir 4 Liter	20663-6
2	Reservoir gasket	22240
3	Motor	60970 60361 60970-1 36400
4	Relief valve 130 psi	B6898
5	Pump block gasket	B6903-1
6	Thread adapter	B6131
7	Elbow 1/8 NPT	A2768
8	Check valve 2 lb.	B4052

Item	Description	Part #
9	Coupling 1/8NPTF	B6539
10	Filler cap	HF705C
11	Street elbow 1/2NPTF	B8930-1
12	Gear pump	25937-1
13	Pump adapter	60715
14	Inlet filter assembly	B5909
15	Thread adapter	B6963
16	Reservoir plug	22390
17	Reservoir plug o-ring	22100-10

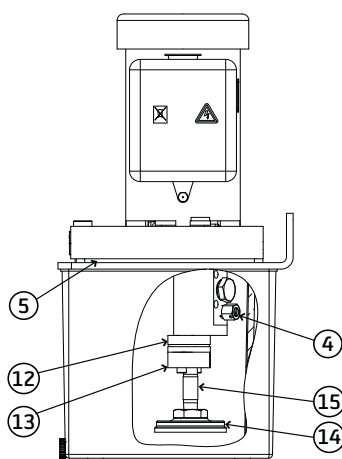
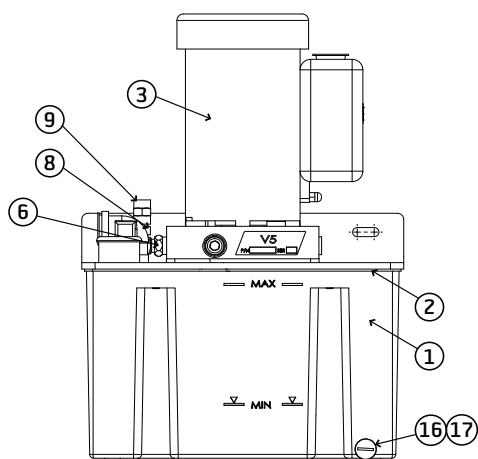
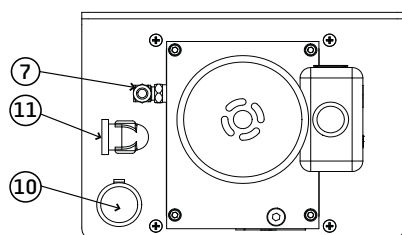

BIJUR DELIMON INTERNATIONAL

(919) 465 4448 LOCAL
(800) 631 0168 TOLL-FREE
(919) 465 0516 FAX

WWW.BIJURDELIMON.COM

2250 Perimeter Park Dr., Suite 120
Morrisville, NC 27560

Dimensional Schematics

Measurements shown in millimeters.

4 Liter Reservoir

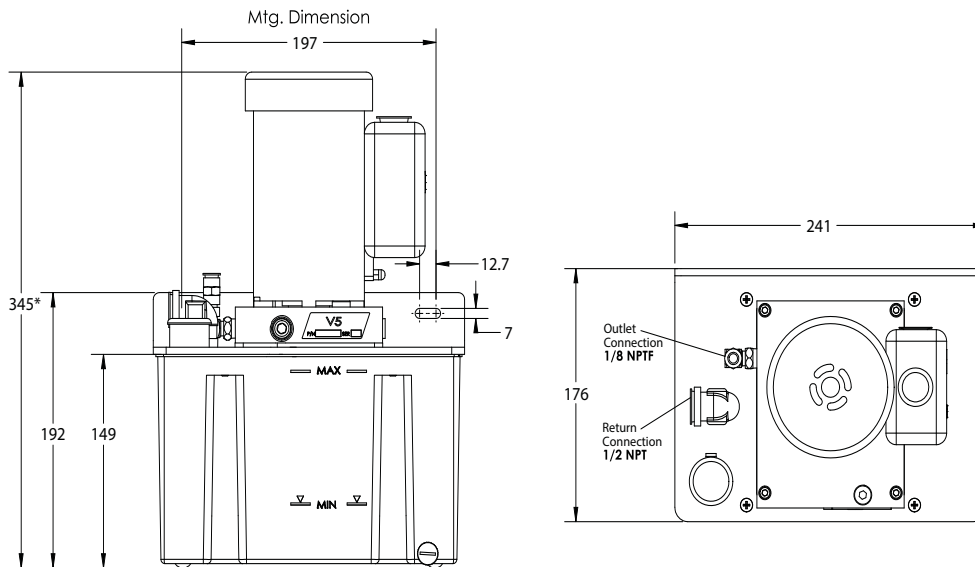

*324 FOR TENV 60970-1

1 Liter Reservoir

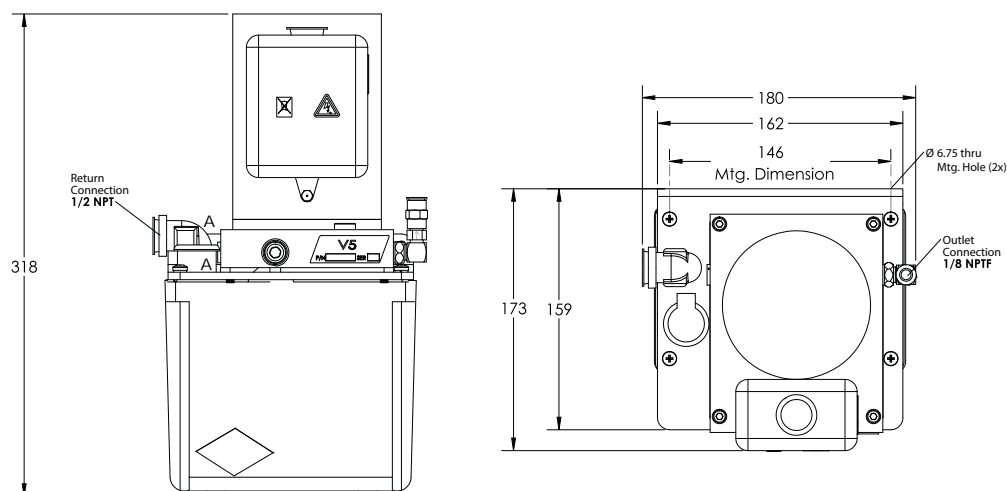

BIJUR DELIMON INTERNATIONAL

(919) 465 4448 LOCAL
(800) 631 0168 TOLL-FREE
(919) 465 0516 FAX

WWW.BIJURDELIMON.COM

2250 Perimeter Park Dr., Suite 120
Morrisville, NC 27560